

DIMENSIONAL SPECIFICATIONS

LEADED BRASS BARSTOCK FITTINGS**

COUPLING

Part #	Size (IN.)	Approx. Net WT. (LB.)	A	B
BS111-02	1/8	0.02	1.00	0.63
BS111-04	1/4	0.04	1.13	0.75

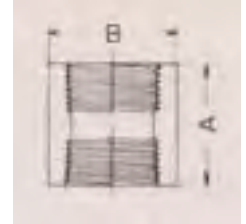

REDUCING COUPLING

Part #	Size (IN.)	Approx. Net WT. (LB.)	E	F
BS112-0402	1/4 X 1/8	0.04	1.13	0.75
BS112-0602	3/8 X 1/8	0.07	1.19	0.88
BS112-0604	3/8 X 1/4	0.06	1.19	0.88

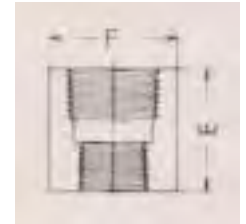

EXTENSION PIECE

Part #	Size (IN.)	Approx. Net WT. (LB.)		
BS232-04	1/4	0.09		



**WARNING: This product contains chemicals known to the state of California to cause cancer and birth defects or other reproductive harm.

**NOTE: This product is not for use in potable water applications and contains a chemical known to cause birth defects or reproductive harm.

**MERIT
BRASS**

DIRECTING THE FLOW OF *Quality*

DIMENSIONAL SPECIFICATIONS

LEADED BRASS BARSTOCK FITTINGS**

HEX HEAD BUSHING

Part #	Size (IN.)	Approx. Net WT. (LB.)	A	B
BS114-0402	1/4 X 1/8	0.02	0.67	0.63
BS114-0602	3/8 X 1/8	0.05	0.75	0.69
BS114-0604	3/8 X 1/4	0.04	0.75	0.69
BS114-0802	1/2 X 1/8	0.09	0.81	0.88
BS114-0804	1/2 X 1/4	0.08	0.81	0.88
BS114-0806	1/2 X 3/8	0.06	0.81	0.88
BS114-1202	3/4 X 1/8	0.16	0.94	1.06
BS114-1204	3/4 X 1/4	0.18	0.94	1.06
BS114-1206	3/4 X 3/8	0.15	0.94	1.06
BS114-1208	3/4 X 1/2	0.11	0.94	1.06
BS114-1612	1 X 3/4	0.22	1.06	1.38

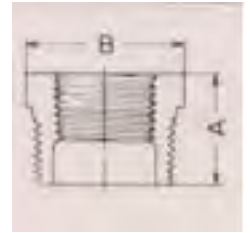

FACE BUSHING

Part #	Size (IN.)	Approx. Net WT. (LB.)		
BS115-0402	1/4 X 1/8	0.01		
BS115-0602	3/8 X 1/8	0.02		
BS115-0604	3/8 X 1/4	0.02		
BS115-0804	1/2 X 1/4	0.05		
BS115-0806	1/2 X 3/8	0.03		
BS115-1206	3/4 X 3/8	0.06		
BS115-1208	3/4 X 1/2	0.05		



**WARNING: This product contains chemicals known to the state of California to cause cancer and birth defects or other reproductive harm.
**NOTE: This product is not for use in potable water applications and contains a chemical known to cause birth defects or reproductive harm.

**MERIT
BRASS**

DIRECTING THE FLOW OF *Quality*

DIMENSIONAL SPECIFICATIONS

LEADED BRASS BARSTOCK FITTINGS**

SQUARE HEAD SOLID PLUG

Part #	Size (IN.)	Approx. Net WT. (LB.)	C	D
BS117A-02	1/8	0.02	0.69	0.28
BS117A-04	1/4	0.04	0.69	0.38
BS117A-06	3/8	0.06	0.82	0.44
BS117A-08	1/2	0.12	0.94	0.56

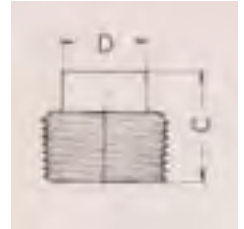

HEX HEAD PLUG

Part #	Size (IN.)	Approx. Net WT. (LB.)	B	E
BS117H-02	1/8	0.02	0.44	0.63
BS117H-04	1/4	0.03	0.63	0.75
BS117H-06	3/8	0.05	0.69	0.88
BS117H-08	1/2	0.08	0.88	0.94
BS117H-12	3/4	0.14	1.06	1.06



SLOTTED HEAD PLUG

Part #	Size (IN.)	Approx. Net WT. (LB.)		
BS117S-02	1/8	0.01		
BS117S-04	1/4	0.02		
BS117S-06	3/8	0.04		



**WARNING: This product contains chemicals known to the state of California to cause cancer and birth defects or other reproductive harm.
**NOTE: This product is not for use in potable water applications and contains a chemical known to cause birth defects or reproductive harm.

**MERIT
BRASS**

DIRECTING THE FLOW OF *Quality*

DIMENSIONAL SPECIFICATIONS

LEADED BRASS BARSTOCK FITTINGS**

HEX COUNTERSUNK PLUG

Part #	Size (IN.)	Approx. Net WT. (LB.)	Hex	Length
BS118HC-02	1/8	0.01	0.19	0.30
BS118HC-04	1/4	0.02	0.25	0.45
BS118HC-06	3/8	0.03	0.31	0.45
BS118HC-08	1/2	0.07	0.38	0.60



HEX LOCKNUT

Part #	Size (IN.)	Approx. Net WT. (LB.)		
BS119-02	1/8	0.02		
BS119-04	1/4	0.04		
BS119-08	3/8	0.04		



CAP

Part #	Size (IN.)	Approx. Net WT. (LB.)	C	F
BS116-02	1/8	0.03	0.69	0.63
BS116-04	1/4	0.02	0.69	0.75

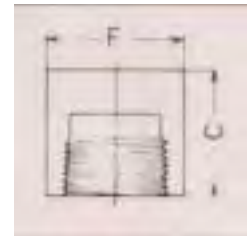

**WARNING: This product contains chemicals known to the state of California to cause cancer and birth defects or other reproductive harm.
**NOTE: This product is not for use in potable water applications and contains a chemical known to cause birth defects or reproductive harm.

**MERIT
BRASS**

DIRECTING THE FLOW OF *Quality*