

Victaulic® Zero-Flex Rigid Coupling Style 07

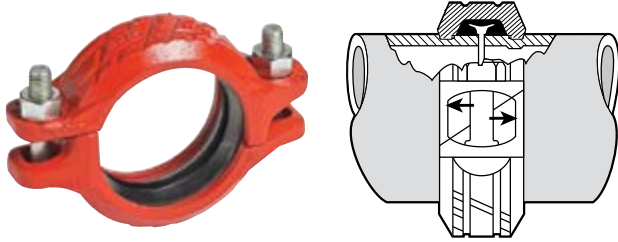

Exaggerated for clarity

Certifications/Listings



104-1a/02

See Victaulic [publication 10.01](#) for details

See Victaulic [publication 02.06](#) for portable water approvals if applicable.

Product Description

The unique angle-pad design of the Zero-Flex® Style 07 coupling adjusts to standard pipe and roll or cut groove tolerances, positively clamping the pipe to resist flexural and torsional loads. The wider key section fills more of the groove area.

The Victaulic standard rigid coupling offering is the Style 107 installation-ready rigid coupling product line. Please reference [publication 06.21](#). For all available sizes, the Style 107 is the standard rigid coupling Victaulic supplies in North America for piping systems using Grade “EHP” or “T” gaskets. Contact Victaulic for further details.

Style 07 couplings are rated up to 750 psi/5175 kPa, dependent on size, for 1 – 12”/25 – 300 mm piping systems. Rigid couplings provide rigidity for valve connections, machinery rooms, fire mains, and long straight runs. Support and hanging requirements correspond to ASME B31.1 Power Piping Code, ASME B31.9 Building Services Code and NFPA 13 Sprinkler Systems. Angle-pad design permits assembly by removing one nut/bolt and scissoring housing over gasket. This reduces the number of components to handle during assembly, speeds and eases installation.

Performance data presented in this document is based on use with standard wall, carbon steel pipe. For use with stainless steel pipe, please reference [publication 17.09](#) for pressure ratings and end loads. When used on light wall stainless steel pipe, the Victaulic RX roll set must be used to roll groove the pipe. For further information regarding roll grooving stainless steel, refer to [publication 17.01](#).

For 14 – 24”/350 – 600 mm sizes Victaulic offers the Advanced Groove System (AGS) line of products. Request [publication 20.02](#) for information on the rigid W07 AGS coupling.

WARNING

- **Victaulic RX roll sets must be used when grooving light-wall/thin-wall stainless steel pipe for use with Victaulic Couplings.**
- Failure to use Victaulic RX roll sets when grooving light-wall/thin wall stainless steel pipe may cause joint failure, resulting in serious personal injury and/or property damage.**

NOTICE

- **Victaulic RX grooving rolls must be ordered separately. They are identified by a silver color and the designation RX on the front of the roll sets.**

Job/Owner

System No.	
Location	

Contractor

Submitted By	
Date	

Engineer

Spec Section	
Paragraph	
Approved	
Date	

Material Specifications

Housing: Ductile iron conforming to ASTM A 536, Grade 65-45-12. Ductile iron conforming to ASTM A 395, Grade 65-45-15, is available upon special request.

Housing Coating: (specify choice)

Standard: Orange enamel.

Optional: Hot dipped galvanized and others.

Gasket: (specify choice¹)

Grade "E" EPDM

EPDM (Green stripe color code). Temperature range -30°F to +230°F/-34°C to +110°C. May be specified for cold and hot water service within the specified temperature range plus a variety of dilute acids, oil-free air and many chemical services. UL Classified in accordance with ANSI/NSF 61 for cold +73°F/+23°C and hot +180°F/+82°C potable water service and ANSI/NSF 372. NOT COMPATIBLE FOR PETROLEUM SERVICES.

Grade "T" Nitrile

Nitrile (Orange stripe color code). Temperature range -20°F to +180°F/-29°C to +82°C. May be specified for petroleum products, air with oil vapors, vegetable and mineral oils within the specified temperature range. Not compatible for hot water services over +150°F/+66°C or for hot dry air over +140°F/+60°C.

NOTE: Additional gasket styles are available. Contact Victaulic for details.

- ¹ Services listed are General Service Guidelines only. It should be noted that there are services for which these gaskets are not compatible. Reference should always be made to the latest [Victaulic Gasket Selection Guide](#) for specific gasket service guidelines and for a listing of services which are not compatible.

Bolts/Nuts:

Heat-treated plated carbon steel, trackhead meeting the physical and chemical requirements of ASTM A 449 and physical requirements of ASTM A 183

Dimensions

Style 07

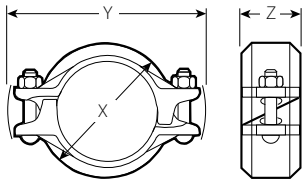

Typical 1 – 12"

Nominal Size inches mm	Actual Outside Diameter inches mm	Maximum Working Pressure ² psi kPa	Maximum End Load ² lbs. N	Allow. Pipe End Separation ³ inches mm	Bolt/Nut ⁴ No. – size inches	Dimensions			Approx. Weight Each lbs. kg
						X inches mm	Y inches mm	Z inches mm	
1 25	1.315 33.7	750 5175	650 2890	0.05 1.2	2 – 3/8 x 2	2.36 60	4.22 107	1.84 47	1.6 0.7
1 1/4 32	1.660 42.4	750 5175	1,620 7210	0.05 1.2	2 – 3/8 x 2	2.69 68	4.62 117	1.84 47	1.6 0.7
1 1/2 40	1.900 48.3	750 5175	2,130 9480	0.05 1.2	2 – 3/8 x 2	2.94 75	5.81 148	1.84 47	1.6 0.7
2 50	2.375 60.3	750 5175	3,320 14775	0.07 1.7	2 – 1/2 x 2 1/2	3.35 85	5.78 147	1.84 47	2.3 1.0
2 1/2 65	2.875 73.0	750 5175	4,875 21695	0.07 1.7	2 – 1/2 x 2 3/4	3.88 98	6.38 162	1.84 47	2.6 1.2
76.1 mm	3.000 76.1	750 5175	5,300 23585	0.07 1.7	2 – 12 x 70.0	4.21 107	6.61 168	1.84 47	3.6 1.6
3 80	3.500 88.9	750 5175	7,215 32105	0.07 1.7	2 – 1/2 x 2 1/2	4.54 115	6.81 173	1.84 47	3.0 1.4
4 100	4.500 114.3	750 5175	11,925 53065	0.16 4.1	2 – 1/2 x 2 3/4	5.81 148	8.21 209	2.07 53	5.3 2.4
108.0 mm	4.250 108.0	750 5175	10,635 47325	0.16 4.1	2 – 12 x 70.0	5.56 141	7.98 203	2.07 53	5.2 2.4
5 125	5.563 141.3	750 5175	18,225 81100	0.16 0.2	2 – 5/8 x 3 1/4	7.03 179	9.89 251	2.07 53	7.4 3.4
133.0 mm	5.250 133.0	700 4825	15,145 67395	0.16 4.1	2 – 16 x 82.5	6.69 170	9.60 244	2.07 53	7.4 3.4
139.7 mm	5.500 139.7	700 4825	16,625 73980	0.16 4.1	2 – 16 x 82.5	6.94 176	9.82 249	2.07 53	7.6 3.4
6 150	6.625 168.3	700 4825	24,130 107380	0.16 4.1	2 – 5/8 x 3 1/4	8.26 210	10.83 275	2.07 53	8.3 3.8
159.0 mm	6.250 159.0	700 4825	21,465 95520	0.16 4.1	2 – 16 x 82.5	7.84 199	10.54 268	2.07 53	9.2 4.2
165.1 mm	6.500 165.1	700 4825	23,225 103305	0.16 4.1	2 – 16 x 82.5	8.13 207	10.84 275	2.07 53	8.3 3.8
8 ⁵ 200	8.625 219.1	600 4130	35,000 155750	0.19 4.8	2 – 3/4 x 4 1/4	10.54 268	13.74 349	2.51 64	15.1 6.8
10 ⁵ 250	10.750 273.0	500 3450	45,400 202030	0.13 3.3	2 – 7/8 x 6 1/2	12.86 327	16.98 431	2.56 65	23.5 10.7
12 ⁵ 300	12.750 323.9	400 2750	51,000 226950	0.13 3.3	2 – 7/8 x 6 1/2	14.86 377	18.88 480	2.56 65	28.2 12.8
14–24 350–600	<p>For 14 – 24"/350 – 600 mm sizes Victaulic offers the Advanced Groove System (AGS) line of products. Request publication 20.02 for information on the rigid W07 AGS coupling.</p> 								

2 Working Pressure and End Load are total, from all internal and external loads, based on standard weight (ANSI) steel pipe, standard roll or cut grooved in accordance with Victaulic specifications. Contact Victaulic for performance on other pipe.

3 For field installation only on roll grooved pipe or cut grooved pipe. Zero-Flex Style 07 couplings are essentially rigid and do not permit expansion/contraction.

4 Number of bolts required equals number of housing segments.

5 Couplings 8, 10, 12"/200, 250, 300 mm sizes available to JIS standards. Refer to [publication 06.17](#) for details.

General Notes

Metric thread size bolts are available (color coded gold) for all coupling sizes upon request. Contact Victaulic for details.

Style 07 couplings must **not** be used to join PVC pipe.

WARNING: FOR ONE TIME FIELD TEST ONLY, the Maximum Joint Working Pressure may be increased to 1 1/2 times the figures shown.

Installation

Reference should always be made to the [I-100 Victaulic Field Installation Handbook](#) for the product you are installing. Handbooks are included with each shipment of Victaulic products for complete installation and assembly data, and are available in PDF format on our website at www.victaulic.com.

Warranty

Refer to the Warranty section of the current Price List or contact Victaulic for details.

Note

This product shall be manufactured by Victaulic or to Victaulic specifications. All products to be installed in accordance with current Victaulic installation/assembly instructions. Victaulic reserves the right to change product specifications, designs and standard equipment without notice and without incurring obligations.

Trademarks

Victaulic® and Zero-Flex® are registered trademarks of Victaulic Company.