

## FIG. 3201R

### Reducing 90° Elbow

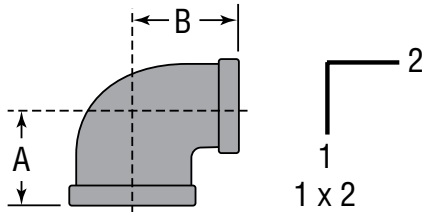

For Listings/Approval Details and Limitations, visit our website at [www.anvilintl.com](http://www.anvilintl.com) or contact an Anvil® Sales Representative.

#### FIGURE 3201R - REDUCING 90° ELBOW

Nominal Size	Max. Working Pressure <sup>▲</sup>	Dimensions		Approx. Wt. Each
		A	B	
1 x 2				
<i>In. (mm)</i>	<i>PSI (kPa)</i>	<i>In. (mm)</i>	<i>In. (mm)</i>	<i>Lbs. (kg)</i>
1 x 1/2 25 x 15	500 3450	1.26 32.00	1.36 34.54	0.44 0.20
1 x 3/4 25 x 20	500 3450	1.37 34.79	1.45 36.83	0.52 0.24
1 1/4 x 1/2 32 x 15	500 34550	1.34 34.03	1.53 38.86	0.64 0.29
1 1/4 x 3/4 32 x 20	500 3450	1.45 36.83	1.62 41.14	0.72 0.33
1 1/4 x 1 32 x 25	500 3450	1.58 40.13	1.67 42.41	0.75 0.34
1 1/2 x 1 40 x 25	500 3450	1.65 41.91	1.80 45.72	0.92 0.42
1 1/2 x 1 1/4 40 x 32	500 3450	1.82 46.22	1.88 47.75	1.08 0.49
2 x 1/2 50 x 15	500 3450	1.49 37.84	1.88 47.75	1.08 0.49
2 x 3/4 50 x 20	500 3450	1.60 40.64	1.97 50.03	1.24 0.56
2 x 1 50 x 25	500 3450	1.73 43.94	2.02 51.30	1.40 0.64
2 x 1 1/4 50 x 32	500 3450	1.90 48.26	2.10 53.34	1.52 0.70
2 x 1 1/2 50 x 40	500 3450	2.02 51.30	2.16 54.86	1.65 0.75

▲ – Working Pressure Ratings are for reference only and based on Sch. 40 pipe. For the latest UL/ULC, and FM pressure ratings versus pipe schedule, please visit [anvilintl.com](http://www.anvilintl.com) or contact your local Anvil Representative.

#### MATERIAL SPECIFICATIONS

Dimensions: ASME B16.3

Material: ASTM A536 Grade 65-45-12

Finish: Black

Threads: NPT per ASME B1.20.1

Agency Approvals: All ductile iron threaded fittings are UL/ULC Listed and FM Approved.

**NOTICE:** Ductile iron fittings have higher tensile strength than that of steel pipe. Therefore, over tightening can cause damage to pipe threads which may cause leakage. Ductile iron fittings should be tightened approximately three turns beyond hand tight, but no more than four turns.

#### PROJECT INFORMATION

#### APPROVAL STAMP

Project:	<input type="checkbox"/> Approved
Address:	<input type="checkbox"/> Approved as noted
Contractor:	<input type="checkbox"/> Not approved
Engineer:	Remarks:
Submittal Date:	
Notes 1:	
Notes 2:	