

DIMENSIONAL SPECIFICATIONS

LEADED DOMESTIC BRASS FLANGES** 150 LB.

COMPANION FLANGE

Part #	Size (IN.)	Approx. Net WT. (LB.)	A	B	C	D	E	F
235-08	1/2	1.05	3.50	2.38	0.59	0.63	0.31	4
235-12	3/4	1.25	3.88	2.75	0.62	0.63	0.34	4
235-16	1	1.85	4.25	3.12	0.69	0.63	0.38	4
235-20	1-1/4	2.10	4.62	3.50	0.81	0.63	0.41	4
235-24	1-1/2	2.75	5.00	3.88	0.88	0.63	0.44	4
235-32	2	4.10	6.00	4.75	1.00	0.75	0.50	4
235-40	2-1/2	7.10	7.00	5.50	1.12	0.75	0.56	4
235-48	3	7.80	7.50	6.00	1.19	0.75	0.62	4
235-56	3-1/2	10.60	8.50	7.00	1.25	0.75	0.69	8
235-64	4	11.55	9.00	7.50	1.31	0.75	0.69	8
235-80	5	15.95	10.00	8.50	1.44	0.88	0.75	8
235-96	6	18.05	11.00	9.50	1.56	0.88	0.81	8

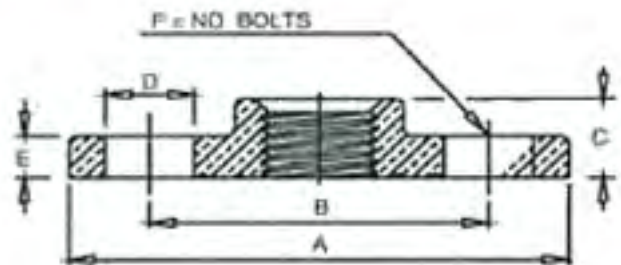

****WARNING:** This product contains chemicals known to the state of California to cause cancer and birth defects or other reproductive harm.
****NOTE:** This product is not for use in potable water applications and contains a chemical known to cause birth defects or reproductive harm.

**MERIT
BRASS**

DIRECTING THE FLOW OF *Quality*

DIMENSIONAL SPECIFICATIONS

LEADED DOMESTIC BRASS FLANGES** 150 LB.

BLIND FLANGE

Part #	Size (IN.)	Approx. Net WT. (LB.)	A	B	C	D	E
235B-12	3/4	1.20	3.88	2.75	4	0.63	0.34
235B-16	1	1.65	4.25	3.12	4	0.63	0.38
235B-20	1-1/4	2.30	4.62	3.50	4	0.63	0.41
235B-24	1-1/2	3.50	5.00	3.88	4	0.63	0.44
235B-32	2	4.55	6.00	4.75	4	0.75	0.50
235B-40	2-1/2	7.15	7.00	5.50	4	0.75	0.56
235B-48	3	11.59	7.50	6.00	4	0.75	0.62
235B-64	4	12.90	9.00	7.50	8	0.75	0.69
235B-96	6	23.50	11.00	9.50	8	0.88	0.81

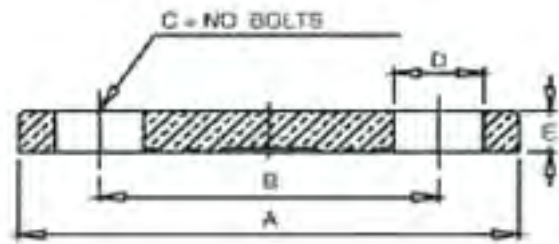

**WARNING: This product contains chemicals known to the state of California to cause cancer and birth defects or other reproductive harm.
**NOTE: This product is not for use in potable water applications and contains a chemical known to cause birth defects or reproductive harm.

**MERIT
BRASS**

DIRECTING THE FLOW OF *Quality*

DIMENSIONAL SPECIFICATIONS

LEADED DOMESTIC BRASS FLANGES** 300 LB.

COMPANION FLANGE

Part #	Size (IN.)	Approx. Net WT. (LB.)	A	B	C	D	E	F
237-16	1	3.00	4.88	3.50	0.69	0.75	0.59	4
237-20	1-1/4	3.90	5.25	3.88	0.81	0.75	0.62	4
237-24	1-1/2	5.65	6.12	4.50	0.88	0.88	0.69	4
237-32	2	6.50	6.50	5.00	1.00	0.75	0.75	8
237-40	2-1/2	9.45	7.50	5.88	1.12	0.88	0.81	8
237-48	3	12.10	8.25	6.62	1.19	0.88	0.91	8
237-64	4	21.30	10.00	7.88	1.31	0.88	1.06	8
237-80	5	26.10	11.00	9.25	1.44	0.88	1.12	8
237-96	6	32.20	12.50	10.62	1.56	0.88	1.19	8

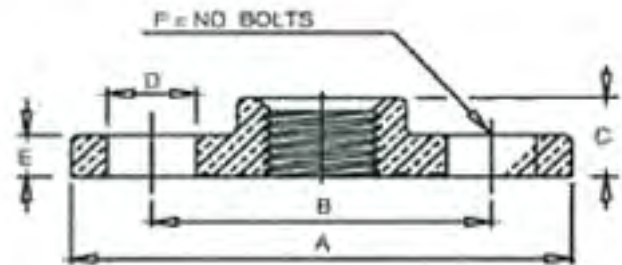

**WARNING: This product contains chemicals known to the state of California to cause cancer and birth defects or other reproductive harm.
**NOTE: This product is not for use in potable water applications and contains a chemical known to cause birth defects or reproductive harm.

MERIT
BRASS

DIRECTING THE FLOW OF *Quality*

DIMENSIONAL SPECIFICATIONS

LEADED IMPORT BRASS FLANGES** 150 LB.

COMPANION FLANGE

Part #	Size (IN.)	Approx. Net WT. (LB.)	A	B	C	D	E	F
X235-08	1/2	0.81	3.50	2.38	0.59	0.63	0.31	4
X235-12	3/4	1.10	3.88	2.75	0.62	0.63	0.34	4
X235-16	1	1.47	4.25	3.12	0.69	0.63	0.38	4
X235-20	1-1/4	1.97	4.62	3.50	0.81	0.63	0.41	4
X235-24	1-1/2	2.53	5.00	3.88	0.88	0.63	0.44	4
X235-32	2	3.83	6.00	4.75	1.00	0.75	0.50	4
X235-40	2-1/2	6.05	7.00	5.50	1.12	0.75	0.56	4
X235-48	3	7.44	7.50	6.00	1.19	0.75	0.62	4
X235-64	4	11.59	9.00	7.50	1.31	0.75	0.69	8
X235-80	5	14.06	10.00	8.50	1.44	0.88	0.75	8
X235-96	6	17.46	11.00	9.50	1.56	0.88	0.81	8

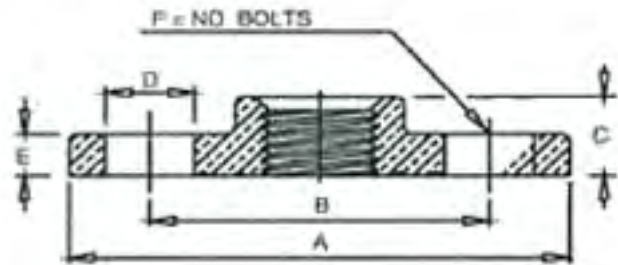

****WARNING:** This product contains chemicals known to the state of California to cause cancer and birth defects or other reproductive harm.
****NOTE:** This product is not for use in potable water applications and contains a chemical known to cause birth defects or reproductive harm.

MERIT BRASS

DIRECTING THE FLOW OF *Quality*

DIMENSIONAL SPECIFICATIONS

LEAD-FREE DOMESTIC BRASS FLANGES* 150 LB.

COMPANION FLANGE

Part #	Size (IN.)	Approx. Net WT. (LB.)	A	B	C	D	E	F
NL235-08	1/2	0.97	3.50	2.38	0.59	0.63	0.31	4
NL235-12	3/4	1.46	3.88	2.75	0.62	0.63	0.34	4
NL235-16	1	1.78	4.25	3.12	0.69	0.63	0.38	4
NL235-20	1-1/4	2.12	4.62	3.50	0.81	0.63	0.41	4
NL235-24	1-1/2	2.54	5.00	3.88	0.88	0.63	0.44	4
NL235-32	2	4.09	6.00	4.75	1.00	0.75	0.50	4
NL235-40	2-1/2	5.97	7.00	5.50	1.12	0.75	0.56	4
NL235-48	3	7.72	7.50	6.00	1.19	0.75	0.62	4
NL235-64	4	11.10	9.00	7.50	1.31	0.75	0.69	8
NL235-80	5	11.94	10.00	8.50	1.44	0.88	0.75	8
NL235-96	6	15.44	11.00	9.50	1.56	0.88	0.81	8

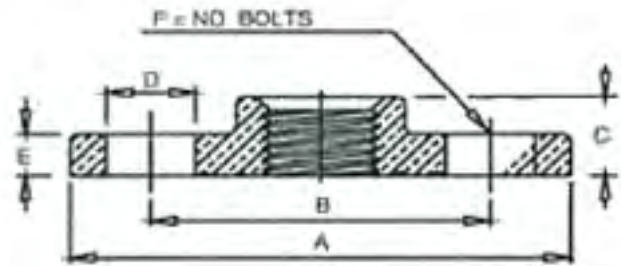

*Conforms with lead content requirements for lead-free plumbing as defined by the U.S. Safe Drinking Water Act. Certified <0.25 weighted average % lead.



MERIT BRASS

DIRECTING THE FLOW OF *Quality*

DIMENSIONAL SPECIFICATIONS

LEAD-FREE DOMESTIC BRASS FLANGES* 150 LB.

BLIND FLANGE

Part #	Size (IN.)	Approx. Net WT. (LB.)	A	B	C	D	E
NL235B-32	2	4.20	6.00	4.75	4	0.75	0.50
NL235B-48	3	8.23	7.50	6.00	4	0.75	0.62

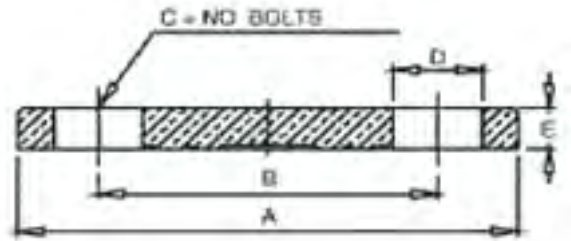

*Conforms with lead content requirements for lead-free plumbing as defined by the U.S. Safe Drinking Water Act. Certified <0.25 weighted average % lead.



MERIT BRASS

DIRECTING THE FLOW OF *Quality*

DIMENSIONAL SPECIFICATIONS

LEAD-FREE DOMESTIC BRASS FLANGES* 300 LB.

COMPANION FLANGE

Part #	Size (IN.)	Approx. Net WT. (LB.)	A	B	C	D	E	F
NL237-48	3	11.60	8.25	6.62	1.19	0.88	0.91	8
NL237-64	4	20.00	10.00	7.88	1.31	0.88	1.06	8

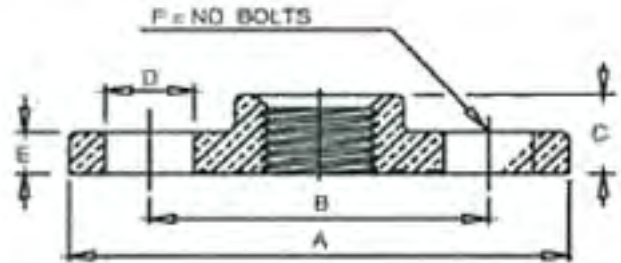

*Conforms with lead content requirements for lead-free plumbing as defined by the U.S. Safe Drinking Water Act. Certified <0.25 weighted average % lead.



MERIT BRASS

DIRECTING THE FLOW OF *Quality*

DIMENSIONAL SPECIFICATIONS

LEAD-FREE IMPORT BRASS FLANGES* 150 LB.

COMPANION FLANGE

Part #	Size (IN.)	Approx. Net WT. (LB.)	A	B	C	D	E	F
XNL235-08	1/2	0.81	3.50	2.38	0.59	0.63	0.31	4
XNL235-12	3/4	1.10	3.88	2.75	0.62	0.63	0.34	4
XNL235-16	1	1.47	4.25	3.12	0.69	0.63	0.38	4
XNL235-20	1-1/4	1.97	4.62	3.50	0.81	0.63	0.41	4
XNL235-24	1-1/2	2.53	5.00	3.88	0.88	0.63	0.44	4
XNL235-32	2	3.83	6.00	4.75	1.00	0.75	0.50	4
XNL235-40	2-1/2	6.05	7.00	5.50	1.12	0.75	0.56	4
XNL235-48	3	7.44	7.50	6.00	1.19	0.75	0.62	4
XNL235-64	4	11.59	9.00	7.50	1.31	0.75	0.69	8

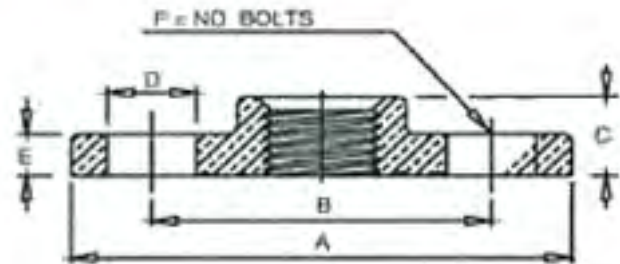

*Conforms with lead content requirements for lead-free plumbing as defined by the U.S. Safe Drinking Water Act. Certified <0.25 weighted average % lead.



MERIT BRASS

DIRECTING THE FLOW OF *Quality*